

Building Sketch (Page - 1)

Client	Shaheen, Ruth, Martin & Fonville Real Estate				
Property Address	7405 Graves Landing Road				
City	Charles City	County	Charles City	State	VA
Appraiser	David L. Hertzler, II	Zip Code	23030		

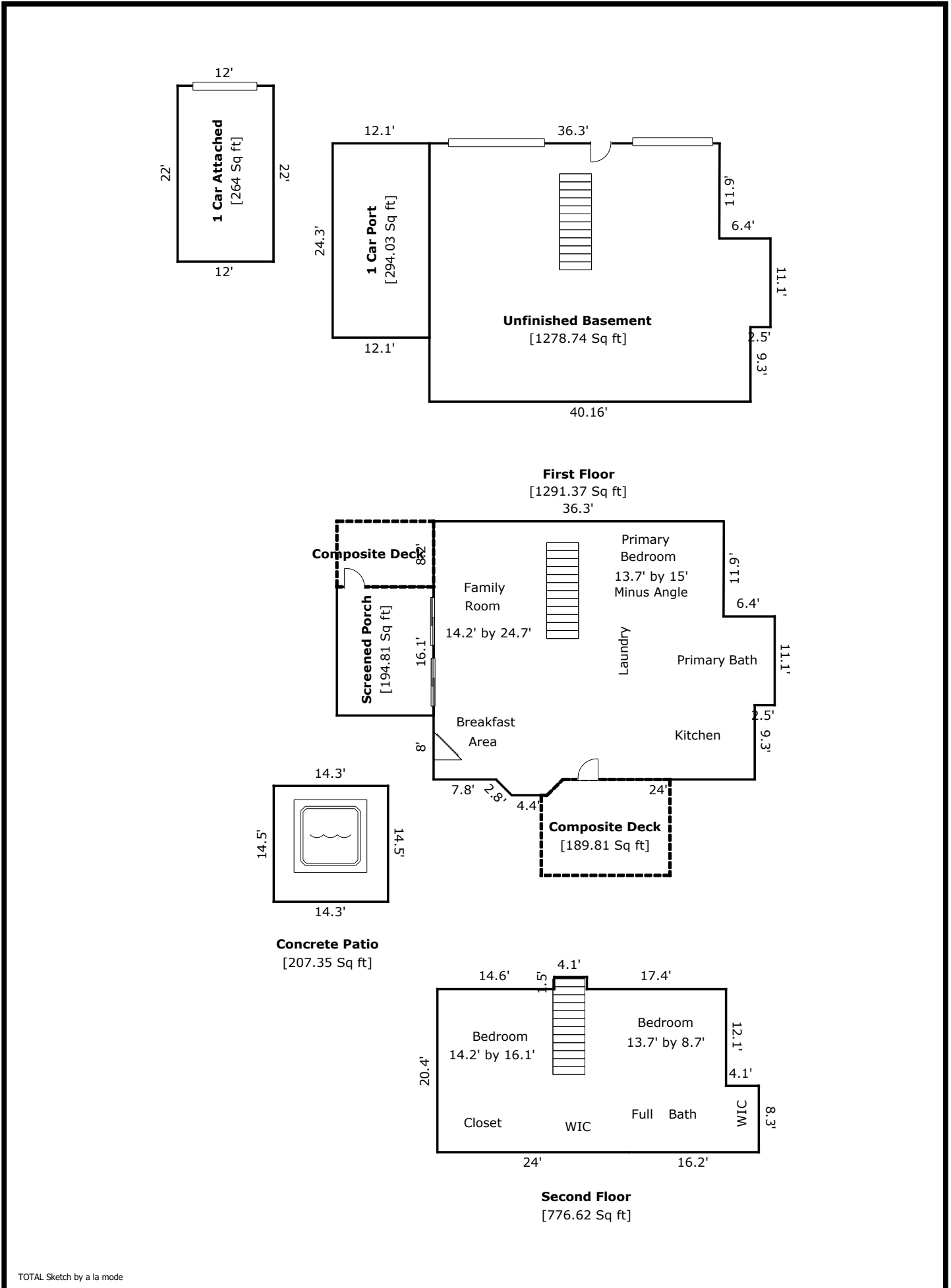

TOTAL Sketch by a la mode

Building Sketch (Page - 2)

Client	Shaheen, Ruth, Martin & Fonville Real Estate				
Property Address	7405 Graves Landing Road				
City	Charles City	County	Charles City	State	VA
Appraiser	David L. Hertzler, II	Zip Code	23030		

TOTAL Sketch by a la mode

Area Calculations Summary

Living Area	Calculation Details		
First Floor	1291.37 Sq ft		
		$0.5 \times 1.98 \times 1.98 =$	1.96
		$0.5 \times 1.98 \times 1.98 =$	1.96
		$4.4 \times 1.98 =$	8.71
		$32.3 \times 36.26 =$	1171.19
		$0.5 \times 11.9 \times 0.04 =$	0.24
		$6.4 \times 11.1 =$	71.04
		$9.3 \times 3.9 =$	36.27
Second Floor	776.62 Sq ft		
		$4.1 \times 1.5 =$	6.15
		$20.4 \times 36.1 =$	736.44
		$4.1 \times 8.3 =$	34.03
Total Living Area (Rounded):	2068 Sq ft		
Non-living Area			
1 Car Attached	264 Sq ft	$22 \times 12 =$	264
Composite Deck	189.81 Sq ft	$12 \times 13.4 =$	160.8
		$2.7 \times 10.02 =$	27.05
		$0.5 \times 1.98 \times 1.98 =$	1.96
Concrete Patio	207.35 Sq ft	$14.3 \times 14.5 =$	207.35
Screened Porch	194.81 Sq ft	$12.1 \times 16.1 =$	194.81
1 Car Port	294.03 Sq ft	$24.3 \times 12.1 =$	294.03
Unfinished Basement	1278.74 Sq ft	$32.3 \times 36.26 =$	1171.19
		$6.4 \times 11.1 =$	71.04
		$3.9 \times 9.3 =$	36.27
		$0.5 \times 11.9 \times 0.04 =$	0.24
Composite Deck	99.22 Sq ft	$12.1 \times 8.2 =$	99.22